



Features

- Spring Return
- Economical
- Plastic housing (condensation-free)
- Ease of installation
- Actuator detachable from the valve
- Compliance with CE

Model Selection

DN	Model	Type	Kvs (m ³ /h)	Close-off Pressure (kPa)
15	MFCO-215/2.0	2-Way	2.0	250
15*	MFCO-215/3.2	2-Way	3.2	200
20	MFCO-220/3.2	2-Way	3.2	200
20*	MFCO-220/4.6	2-Way	4.6	150
25	MFCO-225/5.7	2-Way	5.7	100
25*	MFCO-225/6.8	2-Way	6.8	80
32	MFCO-232/10	2-Way	10.0	80
15	MFCO-315/3.2	3-Way	3.2	150
20	MFCO-320/4.6	3-Way	4.6	100
25	MFCO-325/5.7	3-Way	5.7	100
32	MFCO-332/8.4	3-Way	8.4	80

* most common model and Kvs selected for the respective valve size

Technical Data

Material	Valve Body	Forged Brass
	Seal	Nitrile-butadiene Rubber (NBR)
	Chassis & Cover	High Strength Fireproof ABS Engineering Plastic
Medium	Chilled/Hot Water	
Fluid Temperature	2 ~ 94 °C	
Ambient Temperature	0 ~ 60 °C	
Operating Pressure Limits	PN20 (300psi)	
Connections	Female Threaded BSP	
Power Supply	220 VAC, 50-60Hz	
Power Consumption	6.5W	
Actuator Type	Synchronous motor	
Running Time	Opening: 15s Spring Return: 5s	

Dimension

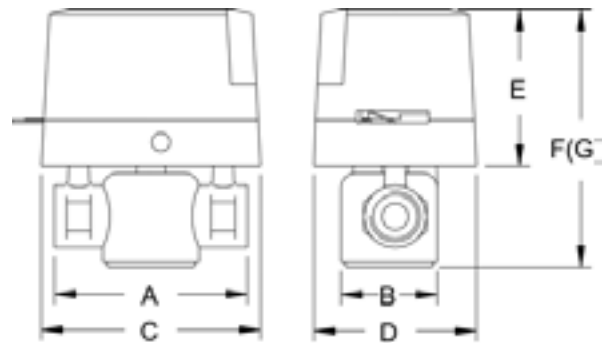

DN	A	B	C	D	E	F(2-way)	G(3-way)
15	80	40	91	68	65	128	138
20	89	44	91	68	65	128	140
25	93	44	91	68	65	130	146
32	105	54	91	68	65	144	159

Wiring

2-way MFCO

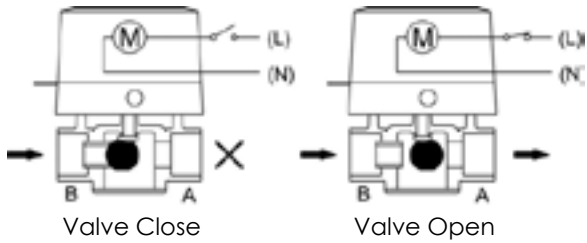

3-way MFCO (Diverting Configuration)

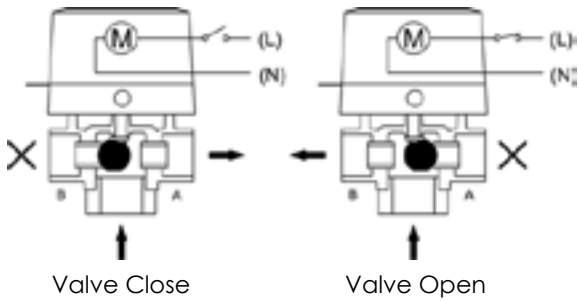

3-way MFCO (Mixing Configuration)

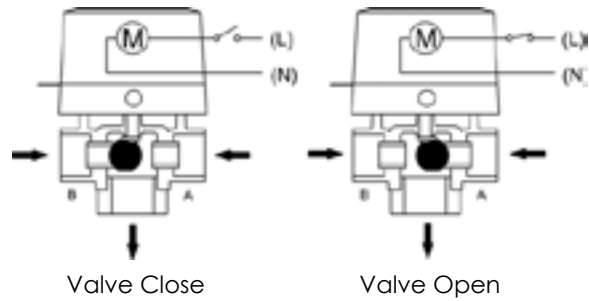

Angle of installation

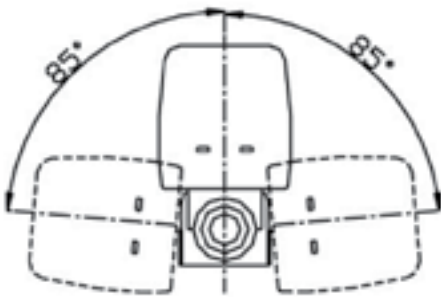

Procedures to detach actuator from valve body

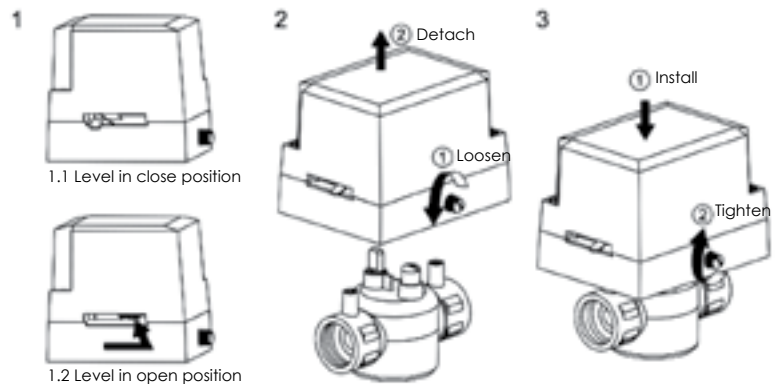

Please remove the handle block after installation

Installation

